



**Sheraton**<sup>®</sup>

KONA  
RESORT & SPA  
AT KEAUFHOU BAY



# Sheraton®

KONA  
RESORT & SPA  
AT KEAUHOU BAY

# Sheraton in Short

Genuine experiences and effortless stays create opportunities to seize the moment.

## **HISTORY**

Situated on the iconic lava rocks of the Kona coast, the Sheraton Kona Resort & Spa flourishes within the historic lands that were once the birthplace and playgrounds of Hawai'i's greatest kings. Today, the resort continues to share the stories of its colorful past through personal connections, indigenous art and local flavors. Come discover the secrets of Heiau Kaukulaelae with weekly cultural tours, locally sourced island cuisine and stunning ocean views.

## **MEETINGS**

With over 100,000 square-feet of function space, we're rethinking the way you meet, trading static spaces for flexible layouts that inspire forward thinking. Maximize meetings in our Kaleiopapa Convention Center and Ballroom, the largest ballroom on the Kona Coast. Thrive in the natural beauty of Hawai'i Island with dedicated meeting rooms and open-air venues overlooking tropical landscapes, stunning ocean views and beyond. Seamless planning, smart technology and energized environments make every meeting dynamic and productive.

## **SHERATON CLUB**

Elevate your stay with the Kaiulu Club Lounge. The Kaiulu Club Lounge is accessible to all guests throughout their stay with the purchase of a Club Room. Guests who are not staying in a Club Room but would like to enjoy the Kaiulu Club Lounge can opt in for a Club Upgrade which would provide access to the Kaiulu Club Lounge. Experience benefits like complimentary breakfast, evening pupu (hors d'oeuvres) with cocktails, and sweeping views along the coast.

## **FOOD & BEVERAGE**

From poolside to oceanside, our food and beverage offerings are sure to satisfy more than your taste buds. With refreshing cocktails and light fare, the Holua Poolside Bar & Lounge is the perfect afternoon retreat to cool down and fuel up. Dine alongside manta rays at Rays on the Bay, where lava-rich soil and deep blue waters meld together to inspire an expertly crafted menu packed with flavor and culinary history.

## **FITNESS**

Our 24-hour access fitness center will keep you motivated with cutting-end equipment and breathtaking ocean views. Or take it outside at our tennis, basketball and sand volleyball courts.

## **SPG**

Maximize every stay with the Starwood Preferred Guest program. Earn Free Night Awards and Award Flights with no blackout dates. For details, visit [spghawaii.com](http://spghawaii.com).



# Sheraton Kona Resort & Spa at Keauhou Bay

78-128 Ehukai Street  
Kailua-Kona, HI 96740  
T 808 930 4900  
sheratonkona.com

## EXPLORE

Discover the dynamic landscape of Hawai'i Island, from snowcapped mountains and the world's most active volcano to black and green sand beaches. Situated on 22 tropical acres along the Kona coast, the Sheraton Kona Resort & Spa is the ideal location to start your adventure. The Flying Fish outfitters provides an all-access pass to Keauhou Bay and beyond. Essential local attractions include:

- 'Akaka Falls
- Hawai'i Volcanoes National Park
- Keauhou Bay Ocean Activities
- Kona Coffee Farm Tours
- Manta Ray Dive Experience
- Mauna Kea Observatory
- Pu'uuhonua O Hōnaunau National Historical Park
- Rainbow Falls
- Waipi'o Valley



## EXPERIENCE

Soak up the vibrant energy of authentic Hawaiian culture. Learn the rich history of the region and the local traditions with our cultural programs. Spark your interest in the sights, sounds and cuisine of Polynesia at the Haleo Lū'au Dinner & Show. Dive into our multi-level pool with a lava tube waterslide, whirlpools and sandy-bottom children's pool. Relax at Ho'ōla Spa, offering Hawaiian therapies and invigorating treatments.

## STAY

Defined by exceptional views and expansive spaces, the Sheraton Kona Resort & Spa is the ideal setting for gathering with family and friends. Recharge from the comfort of our guestrooms and suites, featuring original prints and fabrics by Hawai'i designer Sig Zane. Take advantage of smart amenities as brilliant as the landscape outside your lanai (balcony).

## THE DETAILS

Guestrooms: 508  
Meeting Spaces: 10  
Features: Fitness Center, Ho'ōla Spa, Outdoor Pool, Concierge Services, Sheraton Club, Wedding Chapel



SHERATON KONA RESORT & SPA  
78-128 Ehukai Street  
Kailua-Kona, HI 96740  
T 808 930 4900  
sheratonkona.com



## Innovation Meets Ideation

With over 100,000 square-feet of function space, we're rethinking the way you meet, trading static spaces for flexible layouts that inspire forward thinking. Maximize meetings in our Kaleiopapa Convention Center and Ballroom, the largest ballroom on the Kona Coast. Thrive in the natural beauty of Hawai'i Island with dedicated meeting rooms and open-air venues overlooking tropical landscapes, stunning ocean views and beyond. Seamless planning, smart technology and energized environments make every meeting dynamic and productive.

### BOOK SMART

When you book with Sheraton, you can create a custom website for your event with StarGroups™, our online meeting resource. And with SPG® Pro, you'll have access to intuitive online tools like Reservation Connection to seamlessly upload registration lists and Reservation Cross-Check for up-to-the-minute reporting data on the number of attendees booked.

### REAP THE REWARDS

With SPG®, you can earn Starpoints® for meetings and events you plan. The program rewards your loyalty, giving you the opportunity to redeem Starpoints for Free Night Awards, flights, room upgrades, VIP experiences and more. Visit [sheratonkona.com/meetings](http://sheratonkona.com/meetings) to learn more and start planning.

### GET MORE FROM YOUR STAY

Soak up the vibrant energy of authentic Hawaiian culture. Learn the rich history of the region and the local traditions with our cultural programs. Spark your interest in the sights, sounds and cuisine of Polynesia at the Haleo Lū'au Dinner & Show. Dive into our multi-level pool with a lava tube waterslide, whirlpools and sandy-bottom children's pool. Relax at Ho'ōla Spa, offering Hawaiian therapies and invigorating treatments.

### EXPLORE HAWAII ISLAND

Discover the dynamic landscape of Hawai'i Island, from snowcapped mountains and the world's most active volcano to black and green sand beaches. Situated on the iconic lava rock of the Kona coast, the Sheraton Kona Resort & Spa is the ideal location to start your adventure. The Flying Fish outfitters provides an all-access pass to Keauhou Bay and beyond.



**SHERATON KONA BY THE NUMBERS**

Guestrooms: 508

Number of Meeting Spaces: 10

Total Meeting Space: 100,000 sq. ft.

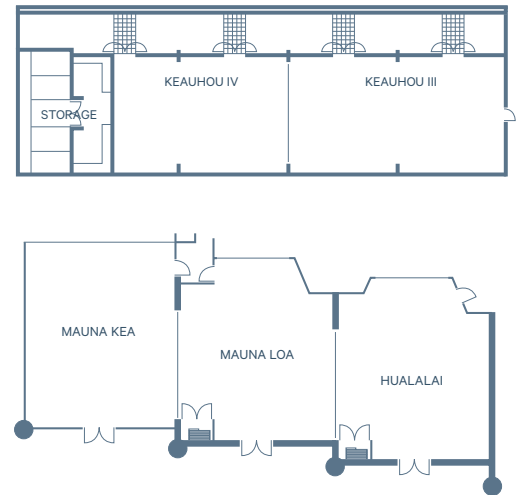
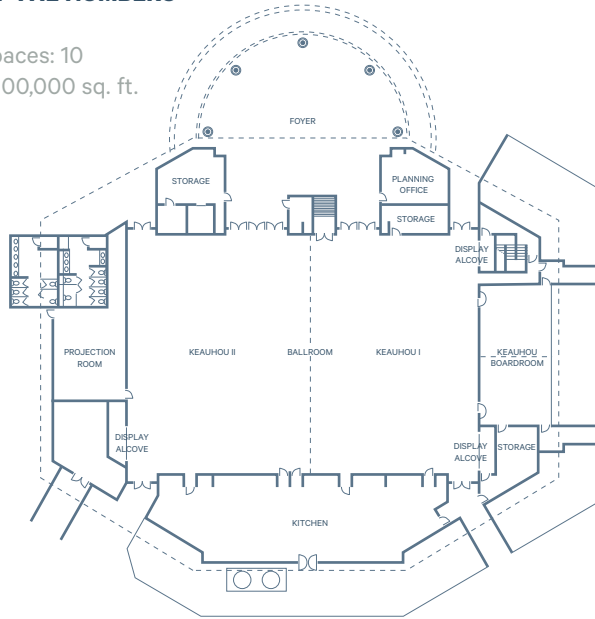

**ROOM DIMENSIONS AND SEATING CAPACITY**

MEETING ROOM	SQUARE FT.	CEILING	BANQUET 66' ROUND	RECEPTION	THEATER	CLASSROOM 6' X 18'
KALEIOPAPA CONVENTION CENTER	9790	21'	650	910	910	630
KEAUHOU I	4240	21'	250	360	300	150
KEAUHOU II	5550	21'	280	460	460	250
KEAUHOU BOARDROOM	1150	11'	50	90	60	40
CONVENTION CENTER FOYER	12920	11'	—	880	—	—
KCC LAWN	5020	—	125	175	175	—
AINAKAI	5140	10'	120	320	—	—
PA'AKAI POINT	4340	—	150	650	—	—
POOL TERRACE	8000	—	300	550	—	—
POOL DECK	26550	—	400	600	—	—
HAWAII LAWN	23150	—	1070	1500	—	—
BAYSIDE WEDDING GARDENS	9730	—	—	—	—	—
CHAPEL	850	21'	—	—	50	—
GAZEBO & LAWN	910	—	—	10	—	—
OVERLOOK	530	—	15	30	25	—
PHOTO GARDEN	8300	—	120	170	—	—
BAYSIDE LAWN	6720	—	150	280	280	—
BAYVIEW GROUNDS	12770	—	700	1400	—	—
FRONT LAWN	42750	—	1850	2600	—	—
KEAUHOU BALLROOM	2660	8'6"	140	220	220	90
KEAUHOU III	1430	8'6"	80	120	120	70
KEAUHOU IV	1230	8'6"	60	100	100	40
BAYVIEW MEETING ROOMS	2870	12'	160	230	230	110
MAUNA KEA	1000	12'	60	60	80	40
MAUNA LOA	940	12'	50	50	75	35
HUALĀLAI	930	12'	50	50	75	35
SUNSET CLIFFS	300	—	8	15	12	—



SHERATON KONA RESORT & SPA  
78-128 Ehukai Street  
Kailua-Kona, HI 96740  
T 808 930 4900  
[sheratonkona.com](http://sheratonkona.com)